

Chicago



design: Bruno Fattorini and Partners

tecnologia: Busnelli_Lab

Eleganza metropolitana, leggerezza di segno, equilibrio nelle proporzioni ed elevato comfort di seduta sono concetti caratterizzanti di questo design. Un sistema divano che permette di disegnare differenti soluzioni compositive, di grande respiro e versatilità, dotato di cuscino schienale basso o alto, offre composizioni personalizzate per vivere il proprio divano nella più totale libertà e comfort. La struttura è in profilato di metallo opportunamente rinforzato e multistrati di legno. Il molleggio di seduta è disposto da cinghie elastiche incrociate. L'imbottitura è in poliuretano espanso senza C.F.C. La composizione dei cuscini seduta è in piuma d'oca 70% e anatra 30% selezionata e sterilizzata "Assopiuma" con anima portante in poliuretano espanso indeformabile senza C.F.C. ricoperta da uno strato di schiuma viscoelastica e fodere in tessuto spigatino 100% cotone. Piedini slitta in trafilato di metallo con finitura verniciata epossidico nei colori nero, bianco o cromato. Completamente sfoderabile esclusa la versione in pelle.

design: Bruno Fattorini and Partners

technology: Busnelli_Lab

Metropolitan elegance, signal of lightness, balance in the proportions and elevated seat comfort are the main characteristic of this model. A modular sofa that allows to create different compositions of wide ranging versatility, with low or high back-rest, offering customized composition to live sofa in total freedom and comfort. The supporting frame is in metal section properly reinforced and in multilayer wood. The spring system of the seat is made of elastic crossed belts. The filling is in C.F.C.-free, non-deformable polyurethane foam. The seat cushions are in selected and sterilized 70% goose feather and 30% duck feather "Assopiuma" with supporting heart in C.F.C. - free, non - deformable polyurethane foam, covered by a layer of viscoelastic foam and with covers in fabric 100% cotton. Slide feet in drawn metal with epoxy varnished finishing in colors black, white or chromed. Completely removable covers except for the leather version.

Chicago

Poltrona / Armchair

Divano / Sofa

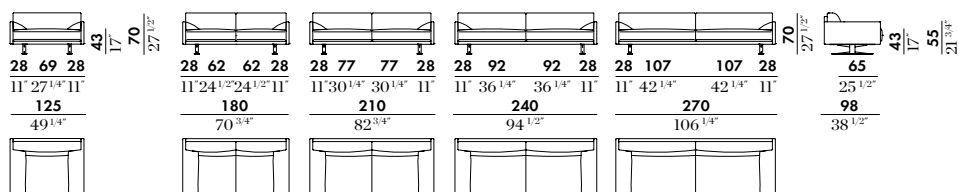

Terminale con bracciolo S.G. o D.G. /
End unit with arm left or right

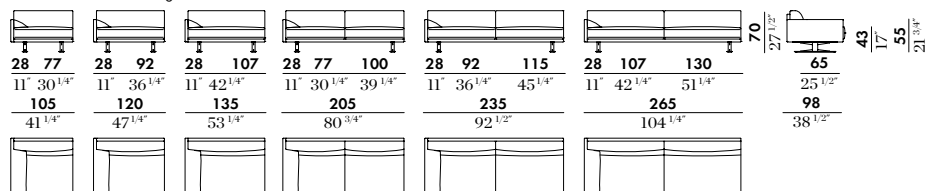

Pouf / Footstool

Terminale con pouf S.G. o D.G. /
End unit with footstool left or right

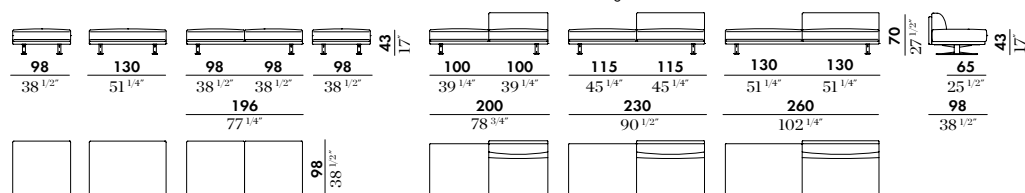

Chicago

Dormeuse con bracciolo S.G. o D.G. /
Long chair with arm left or right

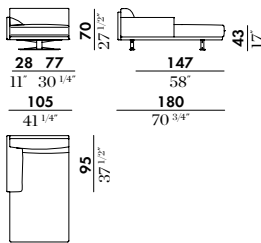

Dormeuse senza braccioli /
Long chair without arm

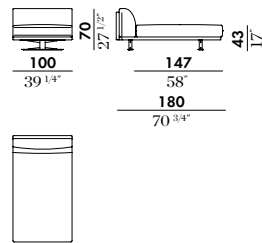

Elemento centrale /
Central unit

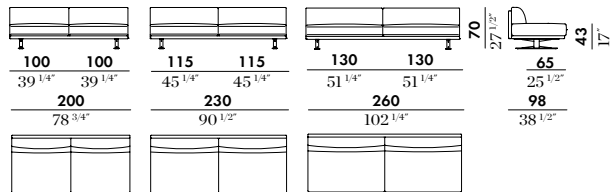

Angolare con pouf S.G. o D.G. /
Corner unit with footstool left or right

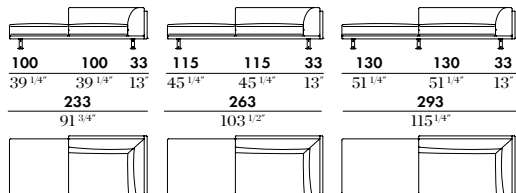

Angolare 133 S.G. o D.G. /
Corner unit 133 left or right

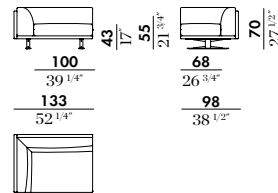

Angolare con bracciolo S.G. o D.G. /
Corner unit with arm left or right

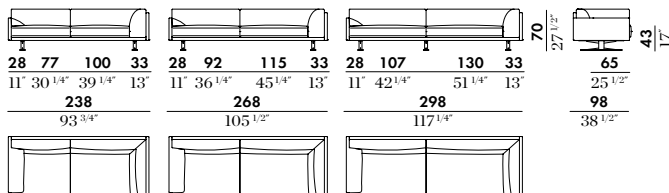

Tutti gli elementi
disponibili con cuscino
schienale + 12 cm
rispetto standard /
All elements are
available with back
cushion 12 cm higher
than the standard

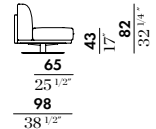

Chicago

Composizione / Composition / 1

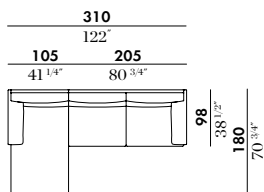

Composizione / Composition / 2

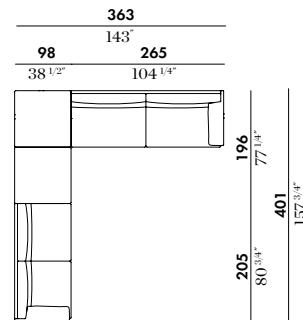

Composizione / Composition / 3

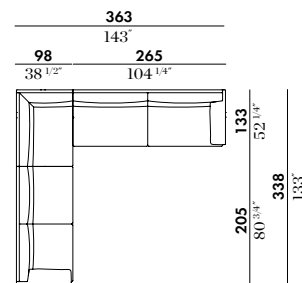

Composizione / Composition / 4

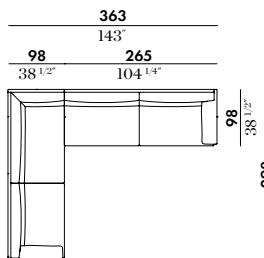

Composizione / Composition / 5

